

Refer
"AGF-12 elevation" extracted from
48670049_080130_0615_VISPROTO_REVIEW[1]

NOTE
Glass details on WSC-P81 to 83

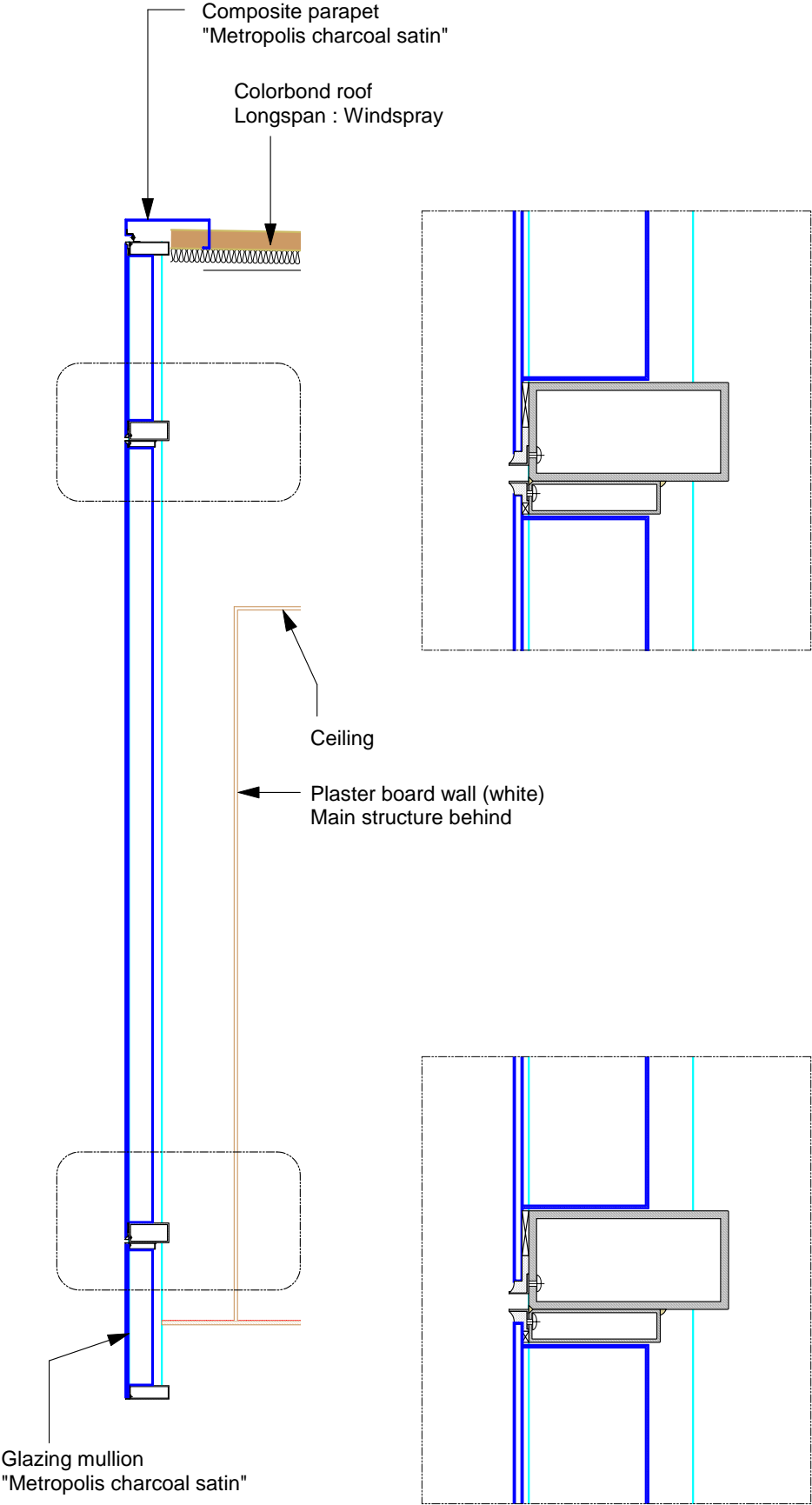
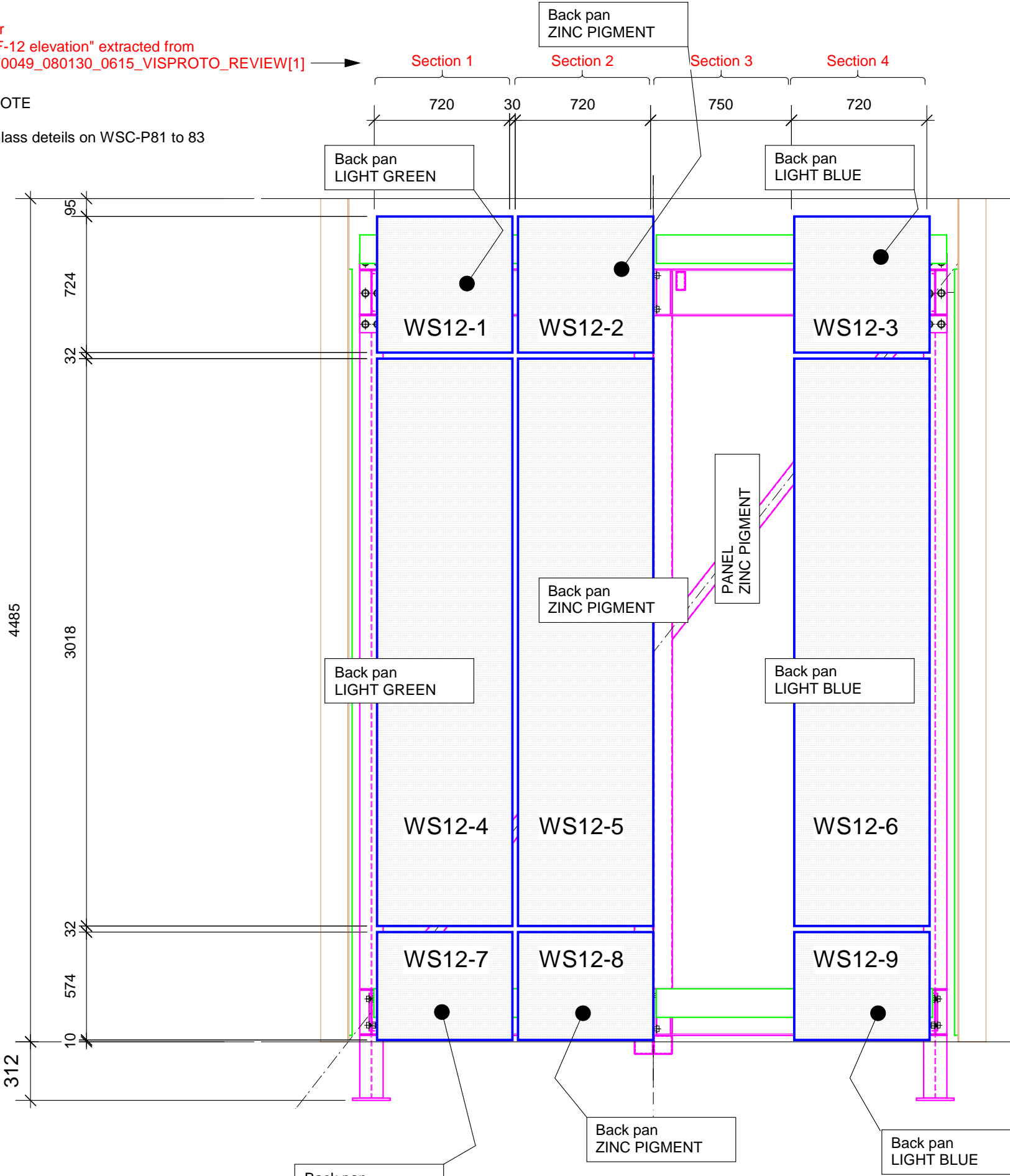

NOTE
Back pan to be provided 3 off each
colour for each size.
Back pans to be removable and
changeable by external access.

BACK PANS
LIGHT GREEN : Dulux PW1-G1 "bargewater"
ZINC PIGMENT : VM Zinc "lichen green"
LIGHT BLUE : Dulux PW2-H3 "frosty"

E03 ELEVATION
AFG-12

E	06.02.08	UPDATE PLASTER BOARD WALL
D	01.02.08	ADD SECTION NUMBER
C	25.01.08	ADD COMMENTS
B	19.12.07	GLASS SIZE REVISED
ISSUE	DATE	REVISION
Use figured dimensions in preference to scale. All dimensions to be verified and checked on site.		
Project		
SYDNEY CITY WESTFIELD PROTO-TYPE		
Fabricator		
 Architectural Fabrications & Installations		
PO BOX 52 SEAFORTH NSW 2092 FAX: 9949 7122 PH: 9948 7861 email: made@alpha.net.au email: jon@made.com.au		
Copyright © 2002 [Made Contracting] All rights reserved		
Drawn		
Builder		
Architect		
Level		
Drawing Title		
AFG-12 ELEVATION		
Scale:	1:25	Checked:
Job Number:	****	Date: 18 Oct 07
Drawing Status		A3
FOR APPROVAL		
Drawing No.	WSC-P 04	Revision
		E